

APPLICATION TO BOARD OF APPEALS

Tel. No. _____

Appeal No. 2017-01

Date 1.11.17

TO THE ZONING BOARD OF APPEALS, WEST SENECA, NEW YORK:

I (we) Rev. John E. Stanton of St. John XXIII Parish

_____, HEREBY APPEAL TO THE ZONING BOARD OF APPEALS FROM THE DECISION OF THE BUILDING INSPECTOR ON AN APPLICATION FOR A BUILDING PERMIT NO. _____, DATED _____, 20____, WHEREBY THE BUILDING INSPECTOR DID DENY TO

- A PERMIT FOR USE
- A PERMIT FOR OCCUPANCY
- A TEMPORARY PERMIT OR EXTENSION THEREOF
- A CERTIFICATE OF EXISTING USE
- A CERTIFICATE OF ZONING COMPLIANCE
- AREA PERMIT

1. Applicant is the PROPERTY OWNER
 CONTRACTOR FOR THE WORK CONCERNED HEREIN
 PROSPECTIVE TENANT
 OTHER (Describe) _____

2. LOCATION OF THE PROPERTY 1 ARCADE ST. W. SENECA NY 14224

3. State in general the exact nature of the permission required, REPLACE EXISTING SIGN WITH NEW LED

4. PREVIOUS APPEAL. No previous appeal has been made with respect to this decision of the Building Inspector or with respect to this property, except the appeal made in Appeal No. NK, dated _____, 20____.

3. REASON FOR APPEAL.

A. A Variance to the Zoning Ordinance is requested because strict application of the ordinance would produce undue hardship, or the hardship created is unique and is not shared by all properties alike in the immediate vicinity of this property and in this use district, or the variance would observe the spirit of the ordinance and would not change the character of the district because: _____

Replace old sign with new electronic one

B. Interpretation of the Zoning Ordinance is requested because: NEW LED SIGN CLOSER THAN 500' TO RESIDENTIAL

C. A Special or Temporary Permit or an Extension thereof Under the Zoning Ordinance is requested pursuant to Article _____, Section _____, Subsection _____, Paragraph _____ of the Zoning Ordinance, because: _____

Rev. John E. Stanton
Signature

TO BE COMPLETED BY THE BUILDING INSPECTOR

1. Provision(s) of the Zoning Ordinance Appealed, including article, section, subsection or paragraph of the Zoning Ordinance
- LED SIGN POLICY REQUIRES 500' BUFFER FROM RESIDENTIAL
- REQUESTING LED SIGN ADJACENT TO RESIDENTIAL

2. Zoning Classification of the property concerned in this appeal R-60(A)

3. Type of Appeal:
- Variance to the Zoning Ordinance.
 - Interpretation of the Zoning Ordinance or Zoning Map
 - Special or Temporary Permit or an extension thereof under the Zoning Ordinance.

4. A statement of any other facts or data which should be considered in this appeal. _____

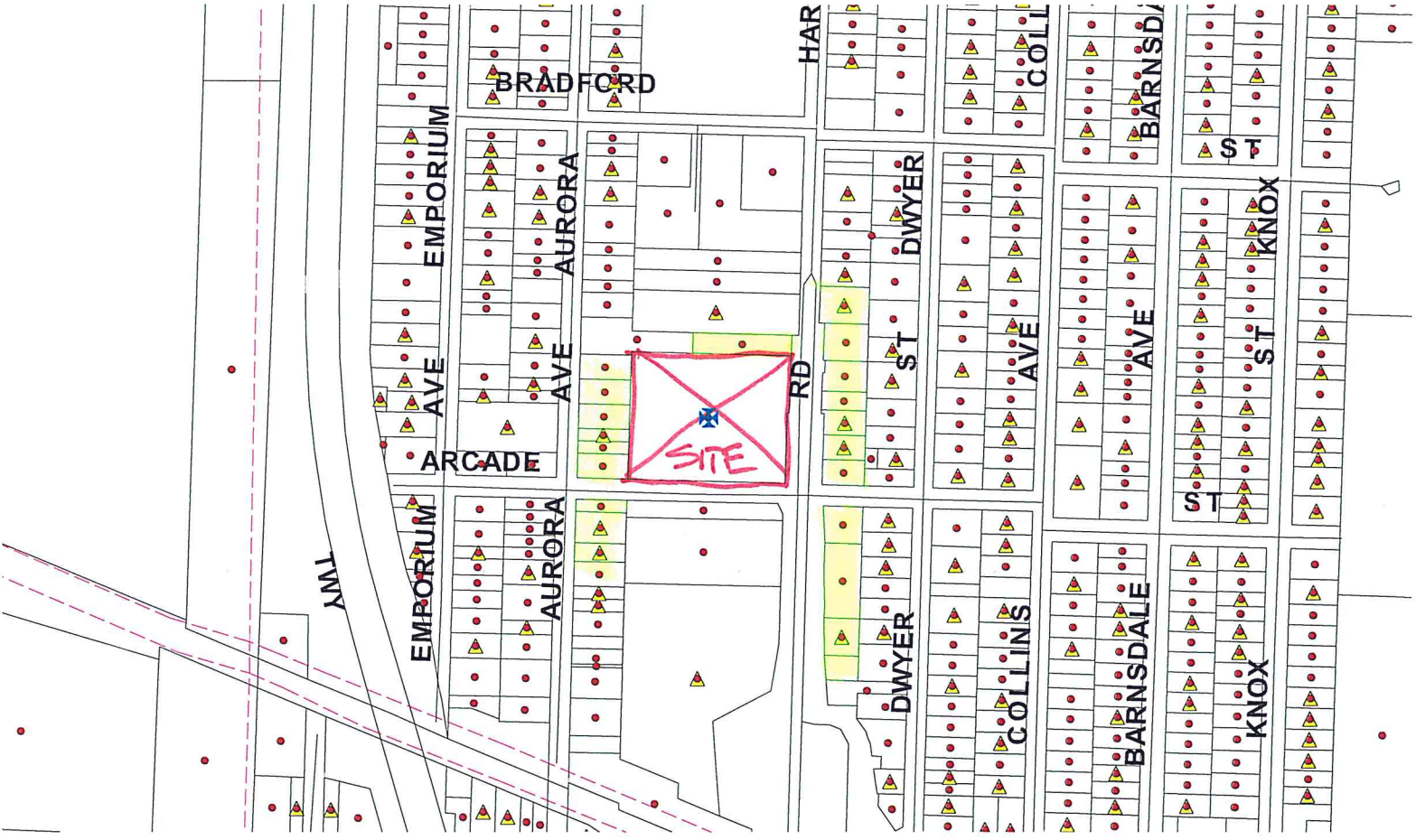

EXISTING SIGN - ST JOHN XXIII



PROPOSED SIGN

