

**DRAWING NOTES:**

1. NEW LOCATIONS OF UTILITY POLES ARE SHOWN FOR REFERENCE. ACTUAL LOCATION HAS BEEN DETERMINED AND STAKED OUT BY NYSEC. CONTRACTOR IS RESPONSIBLE TO FIELD VERIFY THE LOCATION. POLES TO BE RELOCATED BY UTILITY COMPANY.
2. NOT USED
3. TRANSFORMER PAD, BASIS OF DESIGN: LAKELANDS CONCRETE TP1875. EXACT LOCATION OF PAD TO BE DETERMINED IN FIELD. MAINTAIN MINIMUM 12" CLEARANCE BETWEEN UTILITIES. PAD SHOULD BE FULLY CLEAR OF UTILITY POLE GUIDE WIRE.
4. EXISTING TRAFFIC SIGNAL PULL BOX. PULL BOX IS TO BE ADJUSTED TO MATCH NEW DRIVEWAY APRON PROFILE AND THE CAST IRON PULL BOX FRAME SHALL BE REVERSED (WIDE FLANGE AT THE BOTTOM) WHEN POURING NEW CONCRETE APRON.

**GENERAL NOTES:**

1. AREA DESIGNATED AS WETLANDS 'X' IS NOT TO BE DISTURBED AT ANY POINT BEFORE, DURING, OR AFTER CONSTRUCTION.
2. CONSTRUCTION SHALL BE IN ACCORDANCE WITH THE TOWN OF WEST SENECA'S SPECIFICATIONS WHERE APPLICABLE AND/OR SUBJECT TO THE LATEST REVISIONS BY THE TOWN ENGINEER.
3. ALL UTILITY LOCATIONS ARE APPROXIMATE. CONTRACTOR SHALL VERIFY IN FIELD ALL LOCATIONS BEFORE BEGINNING WORK.
4. TREE LOCATIONS SHOWN ARE APPROXIMATE. ALL PLANTING LOCATIONS MUST BE FIELD VERIFIED AND COORDINATED WITH ALL TRADES TO ELIMINATE CONFLICT.
5. ALL FOUR EXISTING DRIVEWAY APRONS ON NY RTE 277 SHALL BE REMOVED IN THEIR ENTIRETY AND GRANITE CURBS SHALL BE RESET TO DEFINE THE NEW DRIVEWAYS OR RESTORE THE FULL HEIGHT CURB SECTIONS.
6. THERE IS UNDERGROUND TRAFFIC SIGNAL EQUIPMENT ADJACENT TO THE CURB ALONG NY RTE 277. ANY DAMAGE TO THIS EQUIPMENT SHALL BE REPAIRED TO THE SATISFACTION OF THE NYSDOT TRAFFIC SIGNAL SYSTEMS SUPERVISOR AT THE CONTRACTOR'S EXPENSE AND IS SUBJECT TO NYSDOT INSPECTION.
7. ALL DRIVEWAYS SHALL HAVE A 1" CURB REVEAL.
8. EXISTING CUT DRIVEWAY CURBS SHALL BE SAWCUT ALONG THE FACE OF CURB TO A DEPTH EQUALLY THE EXISTING ASPHALT PAVEMENT AND NEATLY REMOVED FROM THE BACKSIDE.

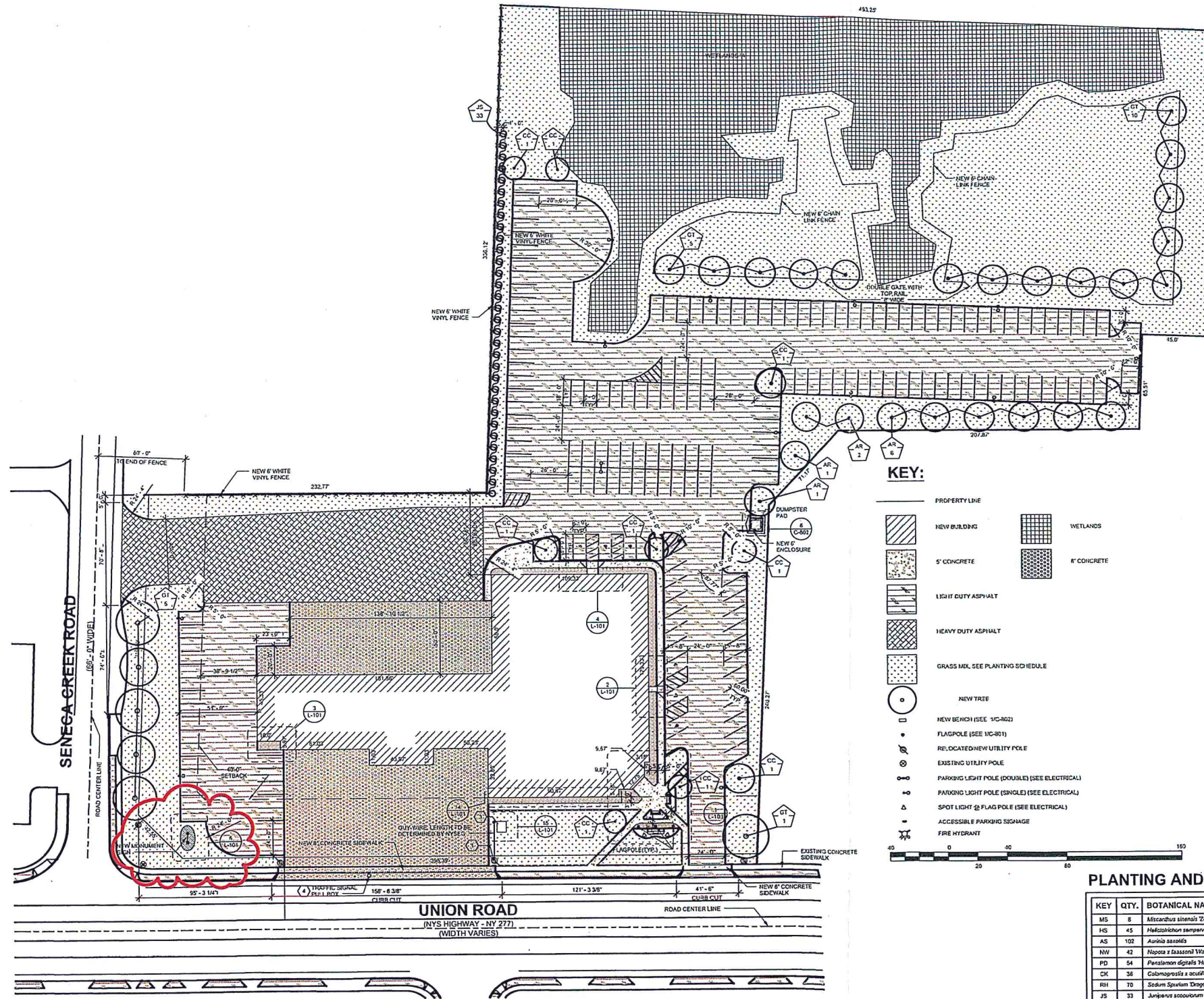

**KEY:**

- PROPERTY LINE
- NEW BUILDING
- 5' CONCRETE
- LIGHT DUTY ASPHALT
- HEAVY DUTY ASPHALT
- GRASS MIX SEE PLANTING SCHEDULE
- NEW TREE
- NEW BENCH (SEE 1/C-102)
- FLAGPOLE (SEE 1/C-101)
- RELOCATED NEW UTILITY POLE
- EXISTING UTILITY POLE
- PARKING LIGHT POLE (DOUBLE) (SEE ELECTRICAL)
- PARKING LIGHT POLE (SINGLE) (SEE ELECTRICAL)
- SPOT LIGHT @ FLAG POLE (SEE ELECTRICAL)
- ACCESSIBLE PARKING SIGNAGE
- FIRE HYDRANT
- WETLANDS
- 6' CONCRETE

**PLANTING AND SEED SCHEDULE**

KEY	QTY.	BOTANICAL NAME	COMMON NAME	SIZE	COMMENTS
MS	8	Miscanthus sinensis 'Zebrinus'	Zebra Grass	CLUMP	
HS	45	Habenaria serpyllifera	Blue Owl Grass	CLUMP	
AS	102	Aurea aurea	Basket of Gold	CLUMP	
NW	42	Niposa x dasycarpa 'Walker's Low'	Walker's Low Catmint	CLUMP	
PD	54	Pentstemon digitalis 'Husker Red'	Husker Red Beard Tongue	CLUMP	
CK	36	Colostephus sp. 'Karl Foerster'	Karl Foerster Reed Grass	CLUMP	
RH	70	Sedum spectabile 'Dragon's Blood'	Dragon's Blood Sedum	CLUMP	
JS	33	Juniperus scopulorum 'Wichita Blue'	Wichita Blue Juniper	3'H	
RF	14	Juniperus scopulorum 'Blue Arrow'	Blue Arrow Juniper	3'H	
TD	19	Thuja occidentalis 'Emerald'	Emerald Green Arborvitae	3'H	
GT	21	Osceola blanda 'Thomas Stayer'	Stayer's Blood Sycamore	32.5" CAL.	
CC	8	Cornus canadensis L.	Eastern Redbud	32.5" CAL.	
AR	10	Aster rubrum	Red Aster	32.5" CAL.	
PL		Poa pratensis & Lolium Perenne	Kentucky Bluegrass & Perennial Ryegrass mix		QUANTITY BY BAG

**1 SITE PLAN**  
1" = 30'-0"

DATE	DESCRIPTION

Project: WEST SENECA FIRE DISTRICT #2  
PROPOSED FIRE STATION  
1845 UNION RD.  
WEST SENECA, NY 14224

Drawing Title: **SITE PLAN**

Designed by: SKM  
Checked by: SKM  
Date: MAY 27, 2016  
Drawing No. C-102

Drawn by: SMJ  
Approved by: HM  
Scale: 1" = 30'-0"  
Project No. 140401  
CAD File No. 140401 West Seneca Fire Station District

**EI Team, Inc.**  
Architect, Engineer, Planner & Construction  
1000 West Seneca Blvd., West Seneca, NY 14224-1470  
(716) 876-6889 Fax: (716) 876-6004

Printed: 01/20/16 3:17:32 PM