

PENNSYLVANIA R.R.

CONTACT PEOPLE FOR UTILITIES  
 SEWER - TOWN OF WEST SENECA Eng. DEPT.  
 WATER - ERIE COUNTY WATER (RUSE)  
 NYS GASE: JOB # 10300094103 (JESSICA)  
 NATIONAL FUEL GAS - KELLY - NEW SERVICES

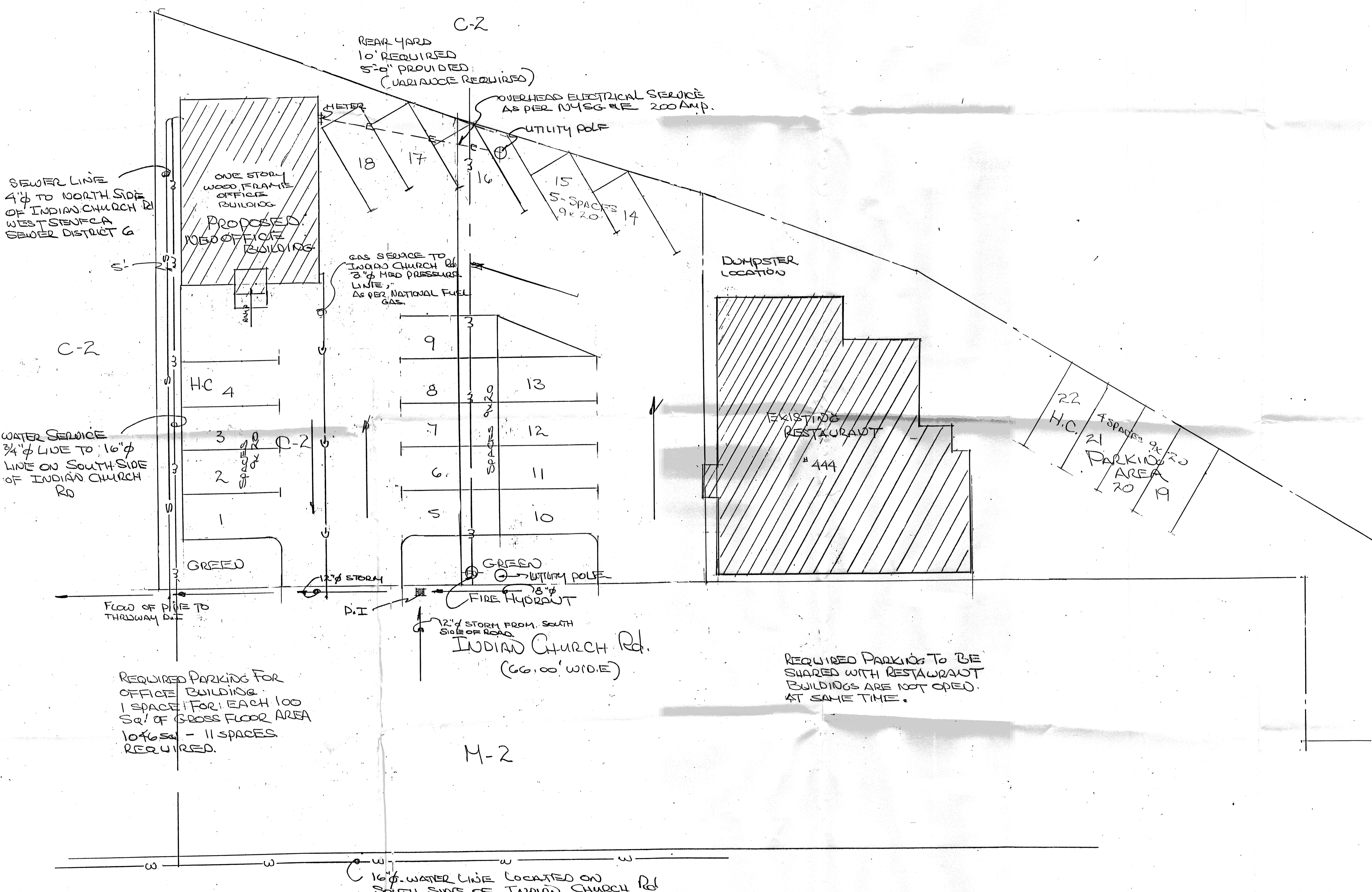

REQUIRED PARKING FOR OFFICE BUILDING  
 1 SPACE FOR EACH 100 Sq' OF GROSS FLOOR AREA  
 10 x 6 sq' - 11 SPACES REQUIRED.

REQUIRED PARKING TO BE SHARED WITH RESTAURANT BUILDINGS ARE NOT OPEN AT SAME TIME.

LOCATION OF NEW BUILDING & UTILITY SERVICE LOCATIONS		
SCALE: 1"=10'	APPROVED BY:	DRAWN BY:
DATE: 1-20-15		REVISED 2-6
444 INDIAN CHURCH RD. WEST SENECA, NY.		
DRAWING NUMBER		1 of 1